

new

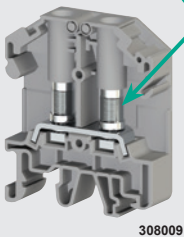

308009

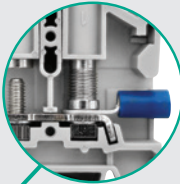
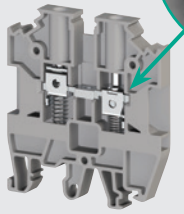
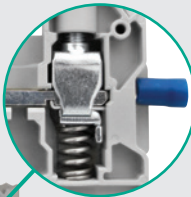

304500



495049

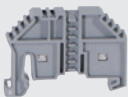

495059



495109



476262

Test / disconnect terminals

Used to perform required tests without disconnecting the system. Usually installed on secondary side of current transformers, permitting observation of testing equipment safe exchange of meters by bridging secondary side of transformer during exchange.

type	wire size (mm ²)	amperage EN60947-7-1	term. width	description
375690	0.5 - 6	41A	8 mm	terminal without test socket
375691	0.5 - 6	41A	8 mm	terminal with test socket
375692	0.5 - 6	41A	8 mm	terminal with double test socket
476302	2 pole	sliding bridge/cross connector		for above test terminals
476303	3 pole	sliding bridge/cross connector		for above test terminals
476304	4 pole	sliding bridge/cross connector		for above test terminals
450229		end plate		for above test terminals

PB6/NM terminal block with screw bolt connection (accommodates ring lugs)

Standard through terminal with threaded stud termination, incorporating a hinged section nut to accommodate a ring lug, provides a secure, safe connection preventing cable from disconnection in the event of loosened screw.

- Universal screw bolt - ring lug connection system (M4)
- Hinged terminal screw for easy access of ring lugs

PB6/NM terminal with stud connection to accept ring lugs

308009	0.5 - 6	41A	11 mm	PB6/NM bolt connection terminal block
451019	end plate	for above bolt connection terminal		308009

AVK Y series spring supported screw connection terminal block

Special application terminal with spring supported screw connection for use with hook blade terminals the spring provides a secure, safe connection, simultaneously preventing hook blade lug from exiting the terminal even in the event of a loosened connection.

304500	0.2 - 4	32A	6 mm	AVKY4 spring assisted terminal block
304510	0.2 - 6	41A	8 mm	AVKY6 spring assisted terminal block
304520	0.5 - 10	57A	10 mm	AVKY10 spring assisted terminal block
450300	end plate	for above spring assisted terminal		304500/10
450260	end plate	for above spring assisted terminal		304520

End stops for all terminals

495049	KD3	econo terminal end stop (screw clamp)		
495059	KD4	terminal end stop (accepts group marker) (screwless clamp)		
495219	KD7	heavy duty terminal end stop (screw clamp)		
495109	KD6A	extra large HD end stop for terminals 50 - 240 mm (screw clamp)		
49613A		ME1-2 group marking support	(for end stops 495059)	

Terminal markers for all Klemsan terminals

- Terminal markers clip directly onto all Klemsan rail mount terminals
- Can be manually marked or printed with **Cembre MG3 thermal printer** (see L-37)

41090N/PS	5 x 10 mm	self marking tag for use with Cembre printer	card of 56
41095/PS	6 x 10 mm	self marking tag for use with Cembre printer	card of 48
41096/PS	8 x 10 mm	self marking tag for use with Cembre printer	card of 32

Comb series bridge pieces (external)

476262	2.5 mm	2 pole	comb bridge for std screw terminal	304120
476263	2.5 mm	3 pole	comb bridge for std screw terminal	304120
476264	2.5 mm	4 pole	comb bridge for std screw terminal	304120
476269	2.5 mm	10 pole	comb bridge for std screw terminal	304120
476272	4 mm	2 pole	comb bridge for std screw terminal	304130
476273	4 mm	3 pole	comb bridge for std screw terminal	304130
476274	4 mm	4 pole	comb bridge for std screw terminal	304130
476279	4 mm	10 pole	comb bridge for std screw terminal	304130
476282	6 mm	2 pole	comb bridge for std screw terminal	304140
476283	6 mm	3 pole	comb bridge for std screw terminal	304140
476284	6 mm	4 pole	comb bridge for std screw terminal	304140
476289	6 mm	10 pole	comb bridge for std screw terminal	304140
476292	10 mm	2 pole	comb bridge for std screw terminal	304150
476293	10 mm	3 pole	comb bridge for std screw terminal	304150
476294	10 mm	4 pole	comb bridge for std screw terminal	304150
476299	10 mm	10 pole	comb bridge for std screw terminal	304150